

Accessori Accessories

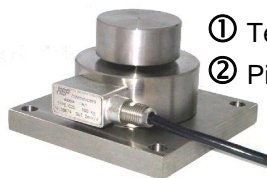

- ① Testa di carico / Loading head
- ② Piastra base / Mounting plate



- ③ Unità di pesatura
Weighing unit

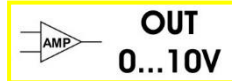
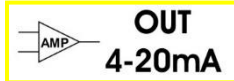
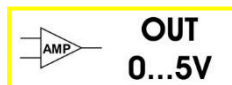
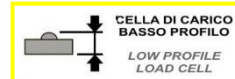

Dimensioni Dimensions

[mm]



LOAD	A	B	C	ØD	ØE	ØF	ØG	H	I	M	n°M	R	ØS	T	U
from 100 kg to 10 t	32	12	11	82	22	68	52.3	44	102	M8	3	50	60	0.3	6
20 t - 30 t	50	14	12	126	35	90	77.3	64	148	M8	3	160	93	0.5	15
50 t - 75 t - 100 t	60	20	20	165	60	130	92.3	80	188	M16	4	300	115	1	17
150 t - 200 t	80	30	20	200	80	152	107	110	223	M16	4	300	128	1	23

LOAD	CODE
100 kg	CC2S82100KC15
250 kg	CC2S82250KC15
500 kg	CC2S82500KC15
1 t	CC2S821TC15
2.5 t	CC2S822T5C15
5 t	CC2S825TC15
7.5 t	CC2S827T5C15
10 t	CC2S8210TC15
20 t	CC2S12620TC15H
30 t	CC2S12630TC15H
50 t	CC2S16550TC15
75 t	CC2S16575TC15
100 t	CC2S165100TC15
150 t	CC2S200150TC15
200 t	CC2S200200TC15

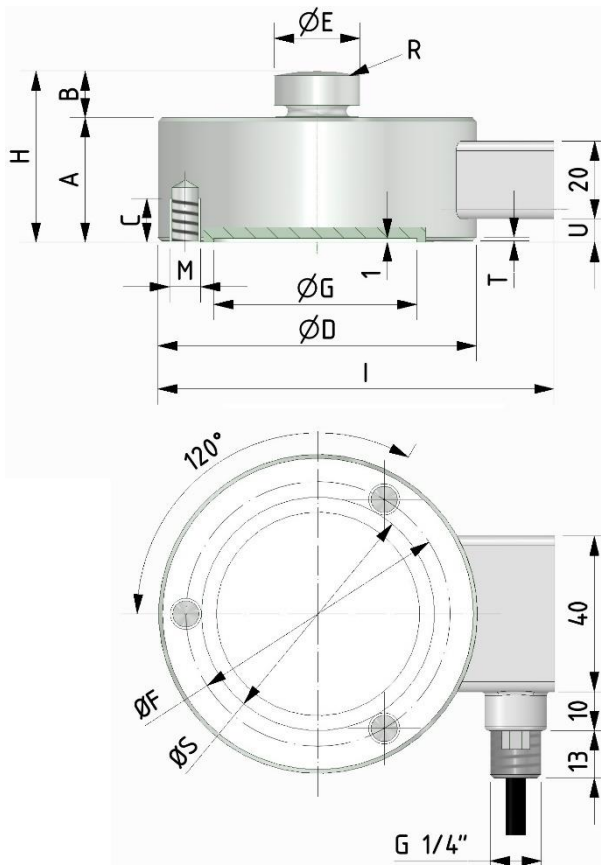

Dati Tecnici
Technical Data

ACCURATEZZA	ACCURACY	0.03 %			
CARICO NOMINALE (E_{max})	NOMINAL LOAD (E_{max})	100 – 250 – 500 kg 1 – 2.5 – 5 – 7.5 – 10 – 20 t 30 – 50 – 75 – 100 – 150 – 200 t			
SENSIBILITA' NOMINALE TOLLERANZA DI CALIBRAZIONE	NOMINAL SENSITIVITY CALIBRATION TOLERANCE	4-20 mA (3 wires), 0...5 V or 0...10 V < ± 0.1 %			
NON LINEARITA' NON RIPETIBILITA'	NON LINEARITY NON REPEATABILITY	$\leq \pm 0.03$ % $\leq \pm 0.01$ %			
EFFETTO DELLA TEMPERATURA (10 °C) a) sullo zero b) sulla sensibilità	TEMPERATURE EFFECT (10 °C) a) on zero b) on sensitivity	$\leq \pm 0.024$ % $\leq \pm 0.017$ %			
ALIMENTAZIONE NOMINALE	NOMINAL POWER SUPPLY	0...5 V \rightarrow 12 ... 24 Vdc 4-20 mA and 0...10 V \rightarrow 18 ... 24 Vdc			
ALIMENTAZIONE MAX. ASSORBIMENTO MAX. (senza carico applicato): RESISTENZA DI CARICO: a) tensione b) corrente RESISTENZA DI ISOLAMENTO BILANCIAMENTO DI ZERO FREQUENZA DI RISPOSTA	MAX. POWER SUPPLY MAX. ABSORPTION (without load applied) LOADING RESISTANCE: a) tension b) current INSULATION RESISTANCE ZERO BALANCE RESPONSE FREQUENCY	28 Vdc 30 mA min. 3 K Ω from 0 to 470 Ω > 2 G Ω ± 1 % ~ 1 kHz			
VALORI MECCANICI LIMITE riferiti al carico nominale: a) carico minimo b) carico di servizio c) carico limite d) carico di rottura e) massimo carico trasversale f) carico dinamico limite	MECHANICAL LIMIT values referred to nominal load: a) minimum load b) service load c) max permissible load d) breaking load e) max transverse load f) max permissible dynamic load	0 % 120 % 150 % >300 % 50 % 50 %			
CARICO NOMINALE	NOMINAL LOAD	100 kg ... 10 t	20 t 30 t	50 t 100 t	150 t 200 t
FRECCIA MAX. AL CARICO NOMINALE	DISPLACEMENT AT NOMINAL LOAD	~0.06mm	~0.16mm	~0.23mm	~0.36mm
TEMPERATURA DI RIFERIMENTO CAMPO NOMINALE DI TEMP. TEMPERATURA DI ESERCIZIO TEMPERATURA DI STOCCAGGIO	REFERENCE TEMPERATURE TEMPERATURE NOMINAL RANGE SERVICE TEMPERATURE STORAGE TEMPERATURE	+23 °C -10 / +40 °C -20 / +70 °C -20 / +80 °C			
PESO	WEIGHT	~1.3 kg	~3.4 kg	~9.4 kg	~18.2 kg
CLASSE DI PROTEZIONE (EN 60529) MATERIALE DELLA CELLA LUNGHEZZA CAVO	PROTECTION CLASS (EN 60529) EXECUTION MATERIAL CABLE LENGTH	IP68 (100h at 1m water column) Acciaio Inox / Stainless Steel 5 m (on request 10 m)			
VITI DI FISSAGGIO: a) diametro b) classe di resistenza c) coppia di serraggio	FIXING SCREWS a) diameter b) resistance class c) tightening torque	M8 12.9 80 Nm	M8 12.9 80 Nm	M16 12.9 230 Nm	M16 12.9 230 Nm

Accelerazione di gravità $g=9.80434 \text{ m/s}^2$ / Acceleration of gravity $g=9.80434 \text{ m/s}^2$.



OPZIONI

Da acquistare separatamente

OPTIONS

To be purchased separately

	CODE	(1) OPZIONE	(1) OPTION
	CMIL6MF	Uscita diretta connettore MIL6M	<i>Direct output connector MIL6M</i>
	CMIL6FV5	CONNETTORE MIL6M femmina 6 poli dritto completo di CAVO PVC schermato lunghezza 5 m.	<i>Female 6 poles straight MIL6M CONNECTOR complete PVC CABLE, shielded, length 5 m.</i>

	CODE	(2) OPZIONE	(2) OPTION
	CONNM12MF	Uscita diretta connettore M12	<i>Direct output connector M12</i>
	CONNM12FV5	CONNETTORE M12x1 femmina 5 poli dritto completo di CAVO PVC costampato schermato lunghezza 3 m.	<i>Female 5 poles straight M12x1 CONNECTOR complete PVC molded CABLE, shielded, length 3 m.</i>

Collegamenti Elettrici *Electrical Connections*

USCITA STANDARD: cavo schermato PVC 105°C, Ø 5.2 mm a 4× Ø 0.35mm² conduttori stagnati.
STANDARD OUTPUT: PVC 105°C shielded cable, Ø 5.2mm with 4× Ø 0.35mm² tinned conductors.

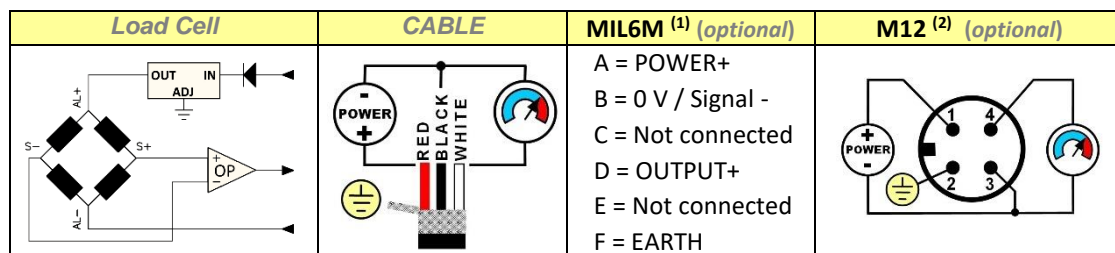

Schermo collegato al corpo del trasduttore.
Shield connected to the body of the transducer.



ATTENZIONE: Proteggere il positivo dell'alimentazione con un fusibile esterno rapido da 100 o 200mA
WARNING: Protect POWER+ by using an external 100 to 200mA fast-blow fuse



AEP transducers

 Dasa-Rägister
 EN ISO 9001:2015
 IQ-1100-01

 ACCREDIA
 L'ENTE ITALIANO DI ACCREDITAMENTO

LAT N° 093
Calibration Centre
 The products are NOT
 covered by accreditation

ATEX 

Production Quality
 Assurance Certified n°
 TÜV CY 17 ATEX 0205891 Q

41126 Cognento (MODENA) Italy Via Bottego 33/A Tel: +39-(0)59-346441 Fax: +39-(0)59-346437 E-mail: aep@aep.it

Al fine di migliorare le prestazioni tecniche del prodotto, la società si riserva di apportare variazioni senza preavviso.
 In order to improve the technical performances of the product, the company reserves the right to make any change without notice.